

The word "ENIGMA" is written in a bold, dark blue, sans-serif font. The letters are stylized, with the 'E' having three horizontal bars and the 'A' having a triangular top. Below the word is a horizontal line of orange dots.

# ENIGMA

ALLIANCE

A wide-angle photograph of a coastal area in Mogadishu, Somalia. In the foreground, there is a sandy, brownish ground with some sparse, dry vegetation. A concrete wall with several vertical posts runs along the left side. In the middle ground, a large, dark, rocky cliffside meets the ocean. Waves are crashing against the base of the cliff, creating white foam. In the background, there are several buildings, including a prominent one with a tower-like structure, and a tall communication tower on the left. The sky is overcast with grey clouds.

Making the  
inhospitable, home

[ Mogadishu, Somalia ]

# Making the inhospitable, home

While the Enigma Alliance portfolio of products can be used anywhere in the world, they were created with the challenging environments of remote site operations in mind.

The products were designed by a team who have extensive experience working in some of the most inhospitable locations on the planet, and who are familiar with the realities of operating in challenging places: areas where drinking local water safely is out of the question, where when it comes to where you lay your head comfort and security is often compromised, and where maintaining fitness and wellbeing is low on the agenda.

The Enigma Alliance team realised what a difference could be made to field operation teams with comfortable and secure accommodation (NapCap), water systems that purify to international standards (WaterCap) and a simple yet well-thought out and durable gym system (GymCap). The vision behind Enigma Alliance is to make the inhospitable, home and to contribute to happier and more productive teams on the ground.

The 'smart' part comes in through the modular design that puts practicality high on the list as well as innovative details: from water systems that can be monitored remotely to fitness facilities that connect you digitally with trainers in the UK – our usability is constantly evolving. All of Enigma Alliances products can be easily transported and quickly assembled or disassembled making them ideal for clients such as Oil & Gas, NGOs, diplomatic, military, construction and disaster relief.

Designed by experts in their fields, built without compromising on quality to ISO standards, clients choose from individual products or a full camp setup as seen in our flagship accommodation camp Chelsea Village in Mogadishu, run by our company Camp Operating Group (COG).

We look forward to working with you.





Our products were created with the challenging environments of remote site operations in mind

# Enigma Alliance



## CHELSEA VILLAGE

Our flagship secure accommodation camp in Mogadishu run by COG, one of the most high-risk environments in the world

## TENTED SOLUTIONS

COG are tented camp specialists providing mobile tented camp, turnkey solutions and support logistics in remote locations



## NAPCAP

High-end container accommodation,  
adaptable to any field operation needs



## WATERCAP

Modular water treatment systems: from  
reverse osmosis to desalination

## GYMCAP

Custom-made modular fitness facilities  
for any environment



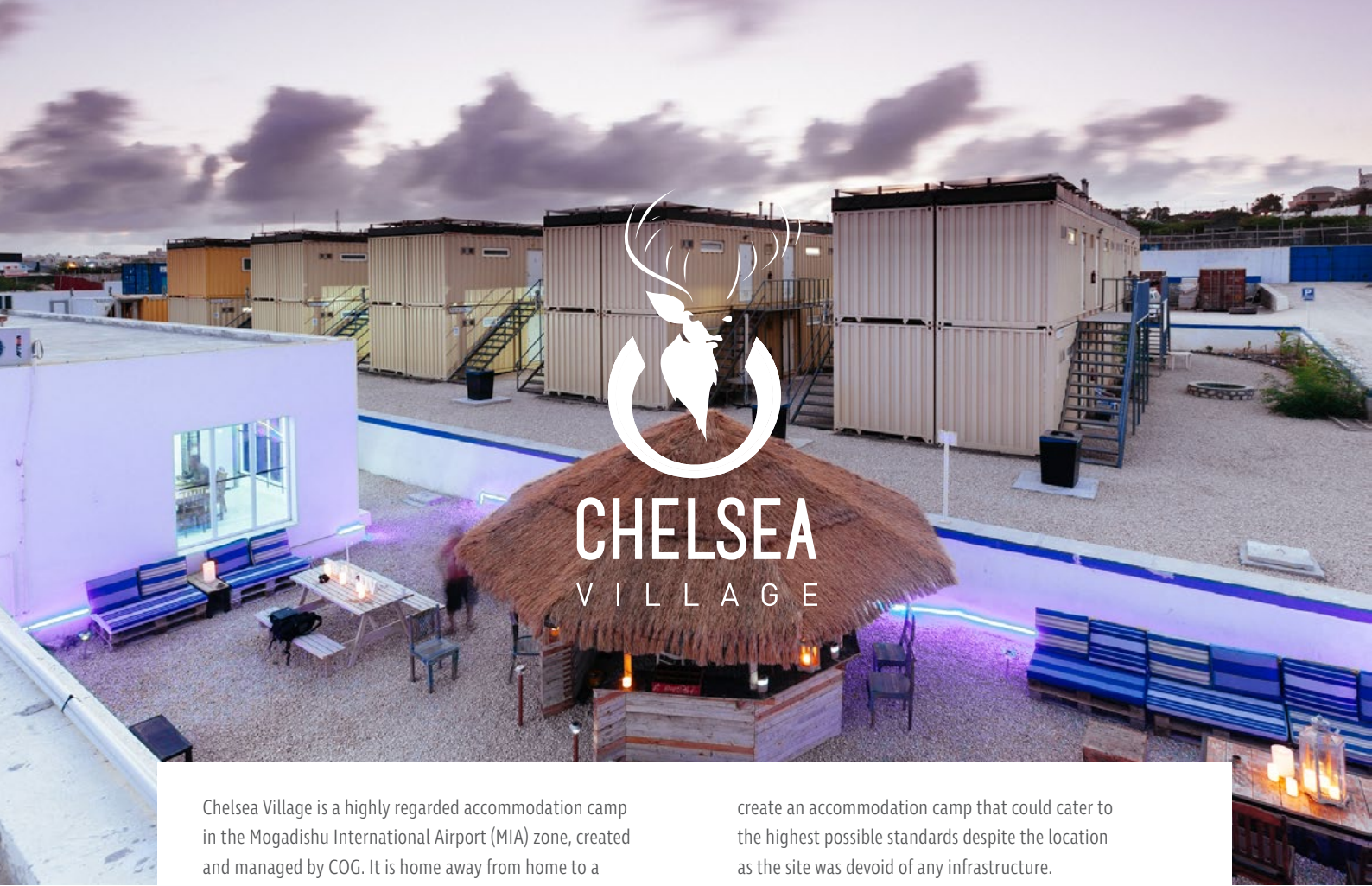

Chelsea Village is a highly regarded accommodation camp in the Mogadishu International Airport (MIA) zone, created and managed by COG. It is home away from home to a variety of guests, including those working for humanitarian and development aid agencies operating in Somalia, and provides a comfortable, secure and quality experience.

Opening its doors in 2015, Chelsea Village is where the Enigma Alliance portfolio comes to life. When building started in 2014, the challenge was to

create an accommodation camp that could cater to the highest possible standards despite the location as the site was devoid of any infrastructure.

Today guests stay in high-end customer-made NapCap container accommodation; drink and shower in potable water to WHO standards due to our WaterCap treatment systems and enjoy the world-class GymCap fitness facility. Chelsea Village continues to grow and improve year on year.

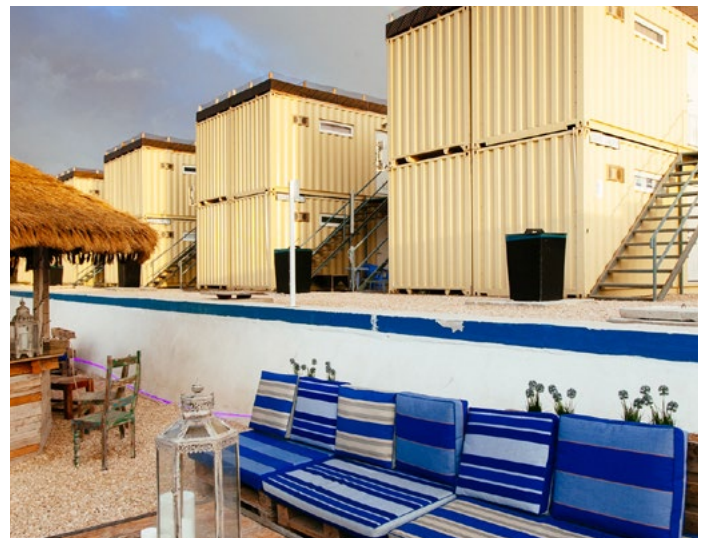

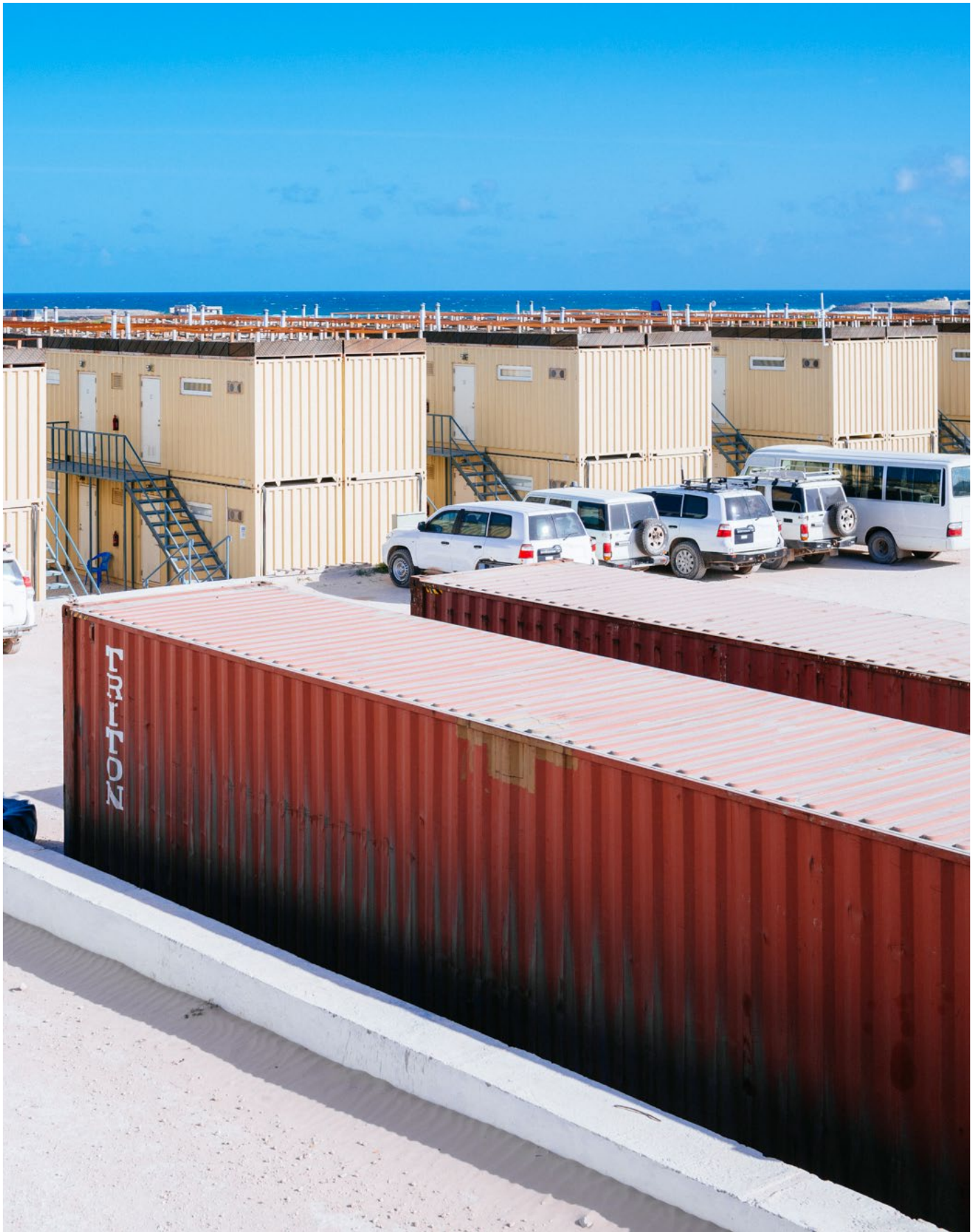





# What Else You'll Find In Chelsea Village



Wi-Fi



Parking



Catering



Laundry



Air conditioning



Power generation



Offices



Video conference facility



UN MOSS compliant security



Bunker



Chelsea Village security manager



Mobile security on request



Potable water to WHO standards



NapCap container rooms



Recreational areas



StuJava Coffee Shop



Local art for sale



GymCap

Our team at Chelsea Village is a mix of both expatriates and locals. Enigma Alliance has a policy of ensuring local communities are part of a sustainable company.

Visit [www.thechelseavillage.com](http://www.thechelseavillage.com) to find out more

'The security provided by the NapCap steel container rooms is the best I've seen and I sleep more soundly at Chelsea Village than anywhere else in Somalia – but maybe that's their double beds!'

LILY S

'The whole set up you have is excellent. Your reputation in country is incredibly high - and we can see precisely why.'

CHRIS G

'Very impressive staff – always helpful and able to provide solutions. I will continue to bring clients.'

MARCUS P



Step inside a NapCap and you'll feel right at home.

Crafted by European shipbuilders to ISO standards, NapCap is container accommodation built with quality, comfort and safety in mind.

An innovative product of superior build quality, the units have been designed by people who have spent years operating in dangerous environments. Easily transportable, able to withstand extreme temperatures, they can be assembled quickly in any location.

We know that while safety is essential, comfort is also key for your team's wellbeing. Made from welded steel with extra over-head protection, the quality build of NapCap provides peace of mind. When you step inside a NapCap you'll see that a lot of attention to detail has gone into the interior design.

Rather than other flimsy prefab accommodation units on the market, NapCap is made from welded steel with extra-overhead protection: it's this quality that provides our customers, many of whom work in field operations, with peace of mind. In a NapCap safety and comfort go hand in hand: every interior detail of the unit has been designed to make the most of the space and maximise wellbeing, from the double bed to the leather sofa to the working nook.

A simple question has to be answered by the team for the units to leave the production line: 'Would I live there?' And the answer is 'Yes. Without a doubt.'







# What You'll Find In a NapCap

Our standard Executive NapCap is a 40-foot container, split into two living spaces each with en-suite shower room. Here's what your new home away from home includes:



Double bed with two drawers



Two seat sofa



Microwave



Bedside table



Office chair



Toilet



Writing desk with four drawers



Mirror



Shower



Wall shelf



Hooks for clothes



Air conditioner



Single wardrobe



LCD TV (32 inches)



Washbasin



TV Cabinet (incl space for refrigerator & books)



Refrigerator

## Why NapCap?



Superior quality



Easy to transport



UN-MOSS Compliant



Adaptable to all environments



Multiple design options



Stackable



Legacy Options



Green Living Support



Cost Effective



Proven Success in Hostile Environments

## What Can NapCap Do For You?

NapCap is both innovative and versatile – if you can imagine it, we can build it for you. We are able to provide variations on our Executive Suite including bunk beds or one large suite in a 40-foot container. Apart from comfortable accommodation, NapCap can create: medical rooms, offices, gyms, temporary embassies, communal entertainment areas, coffee bars and kitchens. We are able to custom-design each unit to suit our clients' requirements.

NapCaps can be stacked, added on to, and easily refitted for a new purpose. Portable (by air, sea and rail), modular, secure, comfortable, and built to European standards, it's NapCap's attention to detail that guarantees a superior service.

Visit [www.napcap-living.com](http://www.napcap-living.com) for more



WaterCap provides innovative, energy-saving global water treatment solutions. Our aim is to provide containerised and fixed water solutions for all types of water treatment.

### REVERSE OSMOSIS

WaterCap uses Reverse Osmosis water purification technology that takes a natural process based on the physical property of semi-permeable membranes to separate water from the substances dissolved in it. By applying appropriate pressure, water forced through the membrane separates into pure water (permeate) and concentrated water (reject). This technology also provides an excellent defence against micro-pollutants, pesticides, viruses and bacteria that may also be found in the water.

### REVERSE OSMOSIS (BRACKISH)

WaterCap's Mobile Containerised units are set up for a wide range of capacities and are built fully equipped with the very latest technology for easy operation and control to meet most demands.

### REVERSE OSMOSIS (SEAWATER)

For arid areas in close proximity to the sea, WaterCap sea water RO units offer a reliable alternative for municipalities, communities, manufacturing and power plants, resorts and other potential users to cover their needs in fresh sweet properly-treated water. WaterCap systems encompass the most recent innovations in membrane and energy recovery technologies which combined with WaterCap engineers' experience and know-how, ensure a long-life and an optimised running cost. In both cases, a proprietary PLC based automation & control software, built into each unit, allows for remote monitoring of all the critical parameters and control of the unit.

### ULTRAFILTRATION

Ultrafiltration or UF is a pressure-driven membrane separation process to remove particulate matter from aqueous solutions such as water. Ultrafiltration membranes have typical pore sizes in the range of 0.01 to 0.10  $\mu\text{m}$  and efficiently remove bacteria and most viruses, colloids and silt. The smaller the nominal pore size, the higher the removal efficiency. WaterCaps Ultrafiltration units provide an efficient way to treat water for re-cycling purposes rendering it suitable for applications such as irrigation or chillers or as an initial pre-treatment stage to a Reverse Osmosis plant.







# Global Service Support



Certified Engineers



Water Technicians



Design & Construction Services



Installation Engineers



Logistics



Remote Monitoring Services

# Why Watercap?

1. Containerised modular solutions allows you to scale up and scale down with ease, allowing our clients affordable options in water treatment
2. Our systems have online monitoring services, 24/7 via GSM. This is a big cost saving as opposed to having a full time engineer on site.
3. WaterCap has proven capabilities in challenging locations, currently providing clean WHO-standard water to a secure camp in Somalia – one of the most austere and hostile environments in the world.
4. The design of our systems gives you the ability to connect and disconnect easily and move the units quickly should the environment become unstable

## CASE STUDY

# Watercap In Mogadishu

### REQUIREMENTS:

To provide European Standard water to accommodation camp in Mogadishu for both drinking and showering, and to ensure ongoing water security for the facility.

### CHALLENGES:

Geography, security, water quality, logistics and procurement.

### OUTCOME:

Fully function 7000-litre per hour containerised drinking water plant providing on demand European standard drinking water direct to the tap for human consumption initially using water via a borehole and then switching to sea water.

“Over the years I've worked in a multitude of high-risk countries and clean water is always one of the most important factors for field operations. With WaterCap, I feel confident that my guests in Mogadishu are getting clean water to global standards. I know that this quality puts their minds at ease too.”

– COSTA YIANNAKIS, CAMP DIRECTOR, CHELSEA VILLAGE



# GymCap

The idea for GymCap came from a team with a background in the military, security and humanitarian industries, who have hands-on experience of living and working in remote countries. They believed that in these stress-heavy environments, health and wellbeing is crucial for those working there, but in high-risk areas freedom of movement isn't always possible.

And so GymCap was born.

A modular fitness facility that provides high quality training solutions, GymCap uses the latest fitness technology and offers a design that can be as elaborate or as simplistic as required. Our standard GymCap consists of a double container setup linked by a fully configured training rig with

a canopy roof system. The beauty of the modular design is that GymCap can be adapted and expanded in size dependent on requirements.

Built to ISO standards, GymCap is a high-end, cost-effective, modular gym that ticks all of the needs for challenging environments: easy to transport, assemble and maintain, functional, resilient and safe, and designed by experts who understand the needs of the end user and appreciate a comfortable and appealing aesthetic.

Phase two of GymCap offers users global connectivity, with online access to personal trainers including rehabilitation and dietary programmes, as well as digital fitness platforms such as Uptivo.

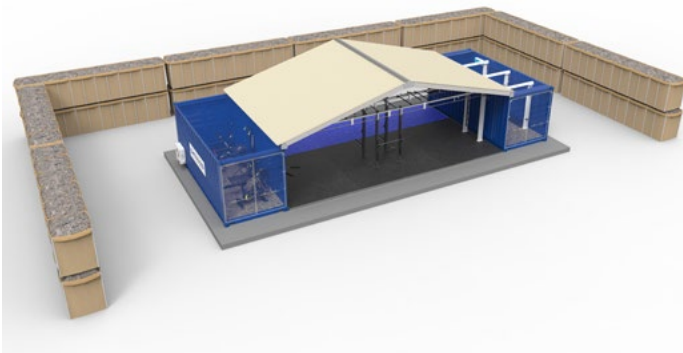

# Gymcap Overview

The newest and most complete outdoor training solution, GymCap is a mobile, containerized functional outdoor training facility.



## ALL WEATHER

The unique training area canopy allows all weather training



## SECURE

Both containers and training equipment fully secure



## CLIMATE CONTROL

Cardiovascular training container fully air conditioned



## LIGHTING

Indoor and outdoor lighting allows for training at any time of day



## MODULAR

Integrated modular storage for all equipment



## CONTAINED

All GymCap components can be containerised for transport

# What You'll Get With GymCap

- 2 x 20' ISO Containers
- 1 x 10m container mounted functional training rig
- Multiple functional training rig attachments
- 1 x Integrated training flooring solution
- 1 x Integrated artificial grass training area
- Standard equipment pack featuring over 150 pieces
- 1 x Secure climate controlled cardiovascular training container
- 1 x Secure functional training container with integrated storage

## WHAT YOU'LL FIND IN A GYM CAP

**CONTAINER ONE:** A cardio equipment unit with the latest low-maintenance, self-powered treadmill, rower, air bike and cross trainers pre-installed.

**CONTAINER TWO:** Includes fitted small equipment, storage and weight-pulley system.

A broad spectrum of small equipment is included that can be adjusted to suit customer requirements. A fully configured training rig links containers.



## Uses of Gymcap



Schools and Educational Institutions



Remotely Located Sports and Fitness Facilities



Performance Sports



Facilities with Restricted Internal Space



Military & Security



Group Exercise



Disabled and Inclusive Facilities

## Warranty

### EXTERNAL FRAMEWORK & STORAGE

10 years anti-corrosion & manufacturer defects

### SMALL EQUIPMENT

12 months manufacturing defect

## 10 NEED TO KNOW FACTS ABOUT GYM CAP

1. The designers and manufacturers of GymCap, is an approved UK MOD Physical Training Equipment Contractor.
2. GymCap is portable and can be deployed or packed in 48 hours using minimal tools and equipment.
3. GymCap is suitable for any terrain, anywhere in the world, providing a total training solution regardless of environment.
4. A modular platform GymCap can be expanded in size and functionality, from a simple gym through to gyms with oxygen chambers for high-intensity training.
5. Containers are fully insulated with heating, ventilation and air-conditioning (HVAC).
6. Energy-efficient LED lighting is installed to the interior and exterior canopies.
7. GymCap has a Duratrain flooring system, engineered for maximum durability and comfort. It is virtually indestructible, UV stable and ideal for intense, high-impact heavy-use environments.
8. Our tested and unique Canopy Roof System is a bolt-together system that requires no cranes or lifting equipment for assembly. It has been both wind and stress tested.
9. GymCap metalwork is fully galvanised and designed to provide a safe and enduring training facility in any environment.
10. GymCap's design principle is 'do no harm'. We consider everything possible to mitigate risk of injury within our training environment.

### CASE STUDY:

## GymCap In High Risk Environments

Location: Chelsea Village, secure accommodation camp in Mogadishu International Airport safe zone.

#### REQUIREMENTS:

Providing a high-end, cost-effective fitness facility that caters to the needs of guests who range from diplomats to security teams to humanitarian aid workers.

#### CHALLENGES:

The physical elements in Mogadishu: high temperatures, corrosive salt air, windy and dusty. Logistical challenge of transportation and set up. No infrastructure in country – GymCap to be completely self-sufficient.

#### THE OUTCOME:

In September 2017, the first GymCap was unveiled at Chelsea Village. Guests included members of government, the UN, British, American and other military, as well as private companies. The GymCap arrived on Somali shores two days prior to the launch, taking only 48 hours for the structure and equipment to be assembled from the containers. GymCap was well received: the high quality of the gym ensures that guests can maintain fitness despite the restriction of movement in the area. An added benefit is that the gym area has become a social hub in the secure camp compound. Thanks to the quality and design of the GymCap (the Duratrain flooring system, the Roof Canopy System) the gym has withstood the harsh elements. The response has been so positive that Chelsea Village now offers gym memberships to other residents in the MIA safe zone.

**"I appreciate this gym due to the open surfaces and great variety of training gear. From strongman equipment to cardio room and traditional gym machines, there's something for everyone. Having worked in close to 20 countries, this is a valid candidate to be my favourite overseas training facility."**

– MEMBER OF US GOVERNMENT



COG are tented camp specialists providing mobile tented camp, turnkey solutions and support logistics in remote locations

### WHY CHOOSE US?

Enigma Alliance has over 25 years either operating or building remote tented secure camp solutions. With operational experience in Iraq, Afghanistan and remote regions of Africa all require a different bespoke solution. COG has the depth of knowledge and ground experience to build locations in the remotest and less logistical places on the globe. Be it from the hostile insecure deserts of Somalia through to the Jungles of Mozambique our team have the experience to deliver









## CASE STUDY

# Mining Industry: Mozambique

### REQUIREMENTS:

Standalone tented camp with 100 capacity; client needed a secure camp facility to support their security operation on the concession on the mine. The location was remote.

### CHALLENGES:

Lack of infrastructure, remote location, wildlife, seasons

### OUTCOME:

A fully functional safari-style tented camp. The process started with a full site survey and scope of requirements – due to lack of infrastructure and availability of equipment the simplest of tasks were big challenges. Enigma Alliance handled all procurement. Meticulous planning of logistics and road moves from South Africa was needed. Despite flash flooding, Enigma Alliance made the construction deadline. Land was cleared without any environmental impact to the natural habitat, inclusive of a clean water source.

## The resulting camp:

### POWER







Supplied by 2 x 64.5 KVA Generators.

### WATER

Supplied direct from the borehole through a water treatment plant with 10,000l stored on demand.









### STAFF ACCOMMODATION

Senior Accommodation consists of seven single man/woman en-suite tents that come equipped with:

-  Single bed, Mattress, Pillow, Duvet
-  Air-conditioning unit
-  Shower, Toilet, Sink, Hot water
-  Lighting
-  Locker
-  Raised concrete pad for flash flooding

### ACCOMMODATION TENTS

This consists of:

-  13 x Tents
-  11 x 8-man tents
-  1 x laundry
-  1 x shower tent
-  2 x converted shipping containers for operations
-  1 x toilet tent
-  1 x kitchen
-  1 x dining room
-  1 x recreation area

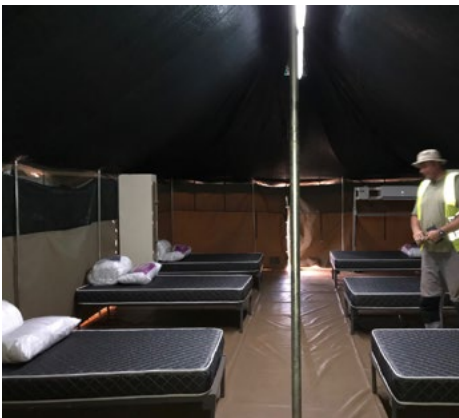

# Contact Enigma Alliance Today

Whether you're interested in our individual products or an entire camp setup, Enigma Alliance is your trusted provider and partner for any remote site solutions needs.

## CONTACT

**Costa Yiannakis, Camp & Services Director, COG**  
cv.manager@thechelseavillage.com  
+252 612 491897

**Colin Laubscher, East Africa Manager**  
colinl@enigma-alliance.com  
+252 619 742957

**Stuart Page, CEO Enigma Alliance**  
stuart.page@enigma-alliance.com  
+44 7833 088 559

[www.enigma-alliance.com](http://www.enigma-alliance.com)  
[www.thechelseavillage.com](http://www.thechelseavillage.com)  
[www.chelseagroupworldwide.com](http://www.chelseagroupworldwide.com)

Find us on LinkedIn, Twitter and Facebook.

